

## MD61xx image barcode scanner quick guide

### Note

- ☞ A standard packing includes a scanner, a USB cable and a CD (or a user manual).
- ☞ Accessories include a stand, a RS232 cable, and a 5V adaptor.
- ☞ Use a piece of dry and soft cloth when cleaning the scanner is in need.

### Parts of the scanner

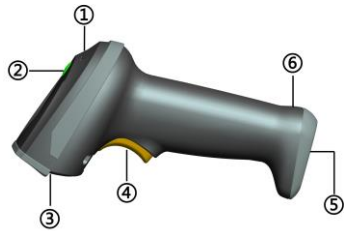

- ① Beeper
- ② LED
- ③ Exit window
- ④ Trigger
- ⑤ Cable interface port
- ⑥ Release-hole of the cable

### Installing the cable

1. Switch off the host;
2. Refer to the below pictures, connect the host with the scanner based on different cables;
3. Ensure that all connections are secure.
4. Switch on the host system. If the installation is successful, the beeper will beep and LED will light.



USB cable



RS232 cable

### Removing the cable

1. Find the release-hole.
2. Insert a thin wire into the hole and pull out the cable gently.



### Reading techniques

1. Press and hold the trigger, an aiming beam is projected which is suggested to be centered over the barcode.
2. In general, the optimal reading range is limited to 5-7cm regardless of the size of the minimal element of the barcode.
3. On a successful reading, the scanner will beep once, and the illumination and aiming patterns die out. Then the scanner transmits barcode message to the host.



### Return default parameters and version information



Default value initialization



Firmware version list

Note: If the reader USB input too fast causing the host can not normally receive data, please scan the barcode below:



## Programming instruction and example

Two programming modes have been provided as bellows:

### ➤ Single-scan setting

Scan the appropriate

Single-scan setting



Example: to set Flow control to be XON/XOFF.

### ➤ Multiple-scan setting

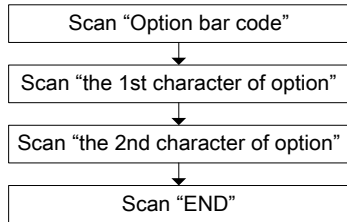

Example: to set Flow control to be XON/XOFF.

## Quick setting to enable/disable Auto-detection

**Note: The stand is an optional accessory.**

Scan the barcode "EN-AutoDete" on the stand to enable Auto-detection.

Scan the barcode "DIS-AutoDete" on the stand to disable Auto-detection. Note: The

Scanning mode will switch to momentary.

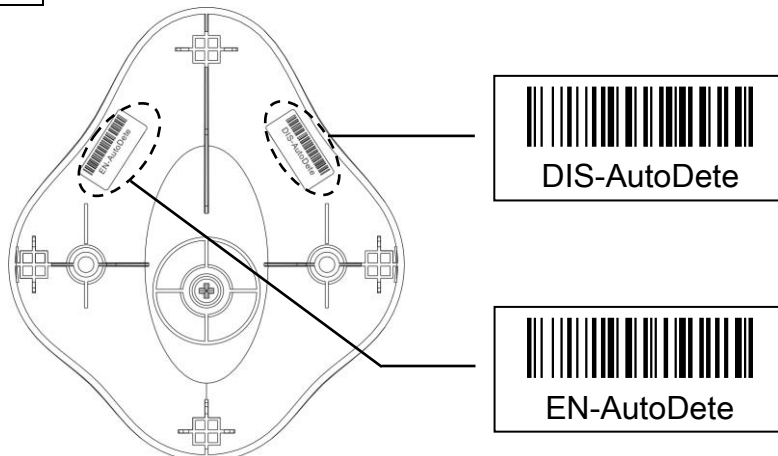

## Assembling the stand

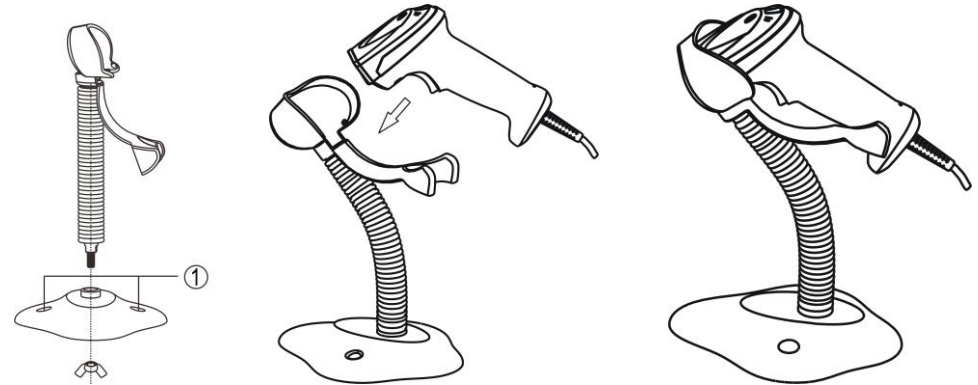

**Note: The stand is an optional accessory.**

1. See the figure above, tighten the screws.
2. Bend the neck to the desired position for scanning.
3. Screw mounting: Screw one #10 wood screw into each screw-mount-hole until the base of the stand is secured.
4. Tape mounting: ①Peel the paper liner off one side of each piece of tape and place the sticky surface over each of the three rectangular tape holders. ②Peel the paper liner off the exposed sides of each piece of tape and press the stand on a flat surface until it is secure.